

Autmix®

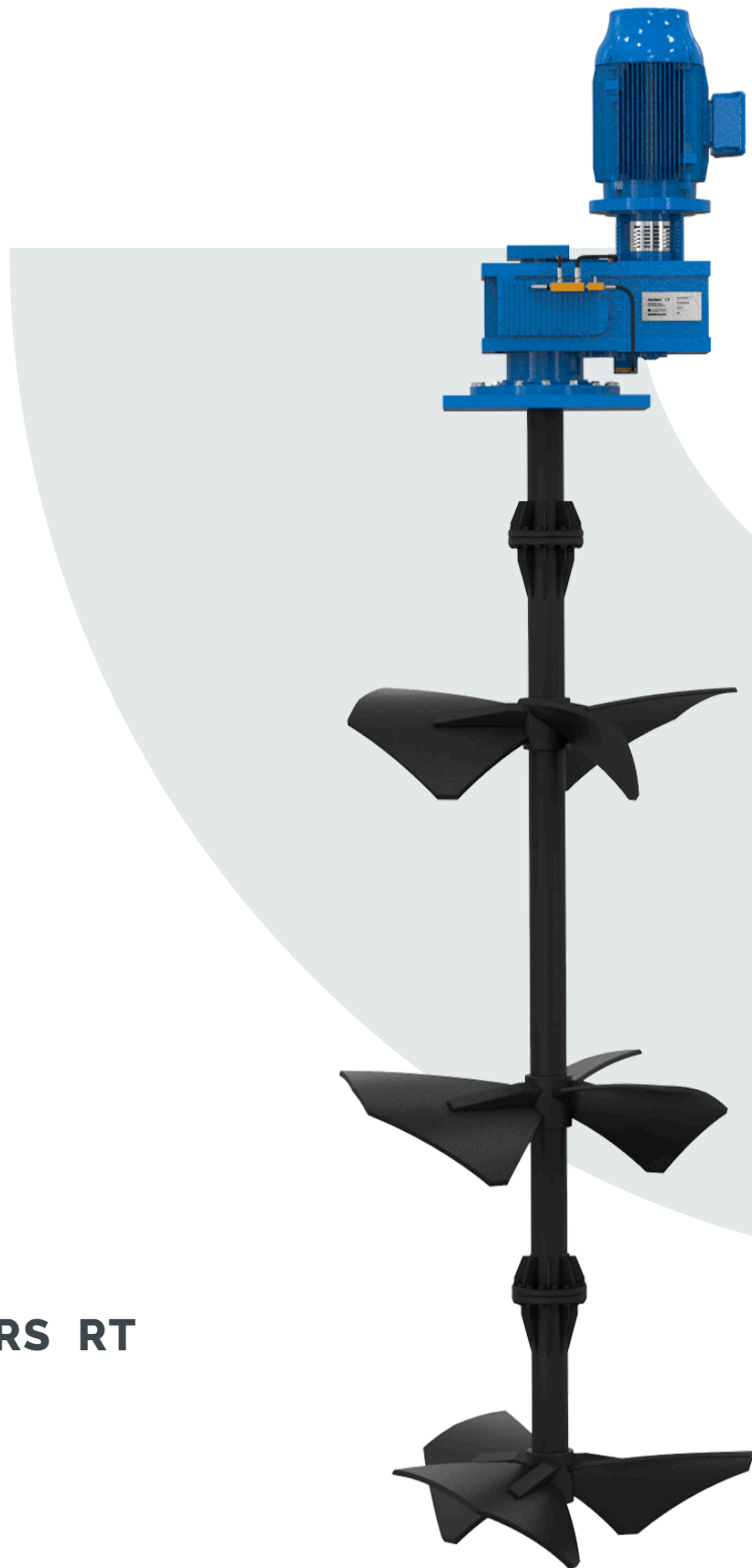

**VERTICAL MIXERS RT
MEGA**

RT(G)

VERTICAL MIXERS RT MEGA RT(G)

MOTOR

- P** 18.5 to 400 kW **Φ** Three-phase
- V** 230 - 460 V IEC: IE3
NEMA: High Premium

GEAR UNIT

- Parallel shaft
- Conical gear

MANUFACTURING MATERIALS

- Carbon steel
- AISI 304
- AISI 316
- Super duplex
- Duplex
- Titanium
- Hastelloy
- Uranus B6

OUTPUT SPEED

20 - 125 RPM

SHAFT-HEAD COUPLING

- Hollow Shaft - Keyway
- Solid Shaft - Coupling
- Hollow shaft - Shrink disk



IMPELLER DIAMETER
2 000 - 10 000 mm

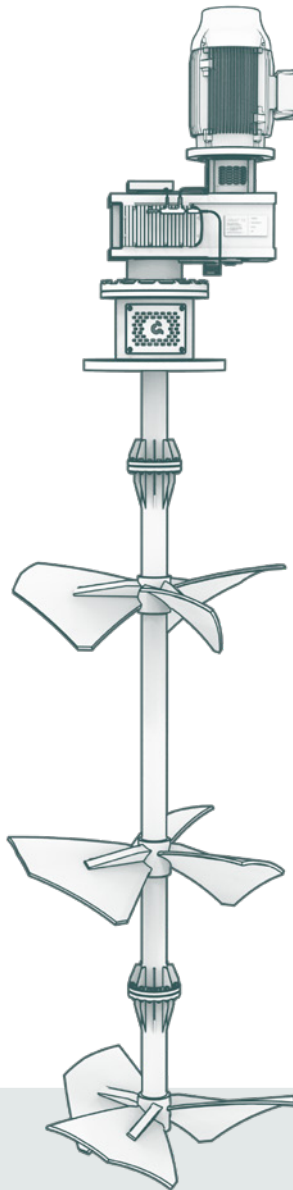

MOUNTING OPTIONS



Flange

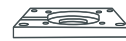

Plate

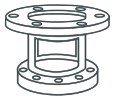

Lantern

SEALING OPTIONS

- Seals
- Cartridge seals
- Cable gland
- Double mechanical seals
- Simple mechanical seals
- Hydraulic labyrinth

SHAFT LENGTH

20 000

15 000

10 000

2 000

mm



SHAFT-IMPELLER COUPLING

- A) Bushing welded to the shaft
- B) Oppressors
- C) Lugs
- D) key-keyway

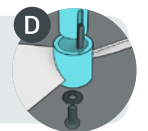
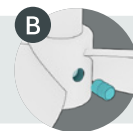
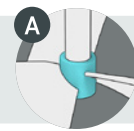

COMPATIBLE IMPELLERS

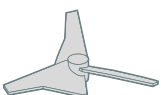

GAMMA

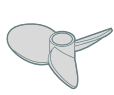

STOKES

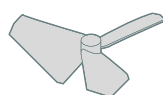

NABLA



SABRE

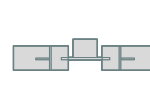

RUSTHON

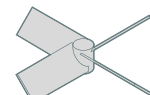

AXIAL TURBINE

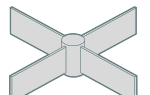

RADIAL TURBINE

RELATED INDUSTRIES



VERTICAL MIXERS RT MEGA RT(G)

REACTOR PRESENTATION

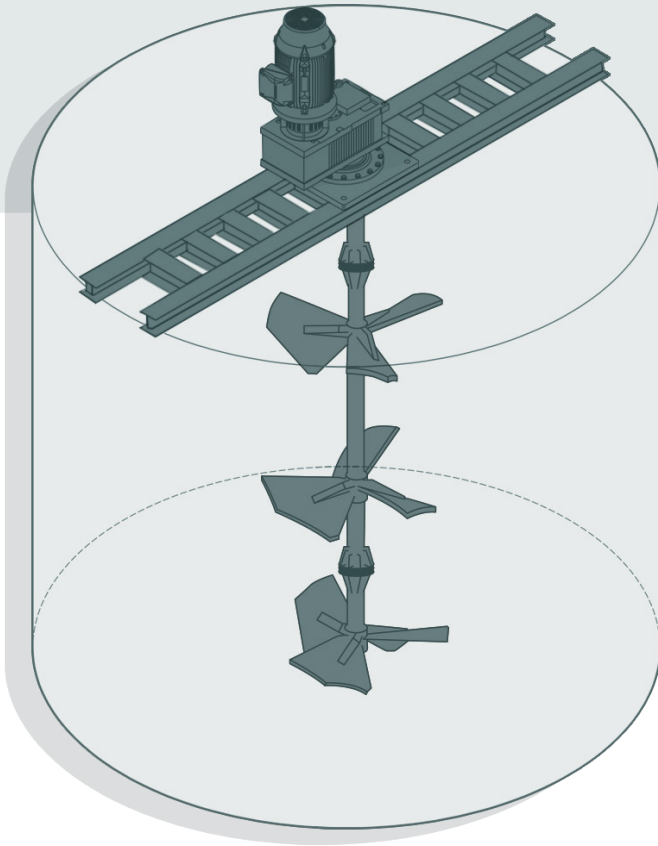

FINISHES AND COATINGS

- PTFE
- PVDF
- EPDM
- Halar
- Butyl rubber
- Natural rubber
- Ebonite
- Neoprene
- Fiberglass
- Sanitary polishing

REACTOR VOLUME

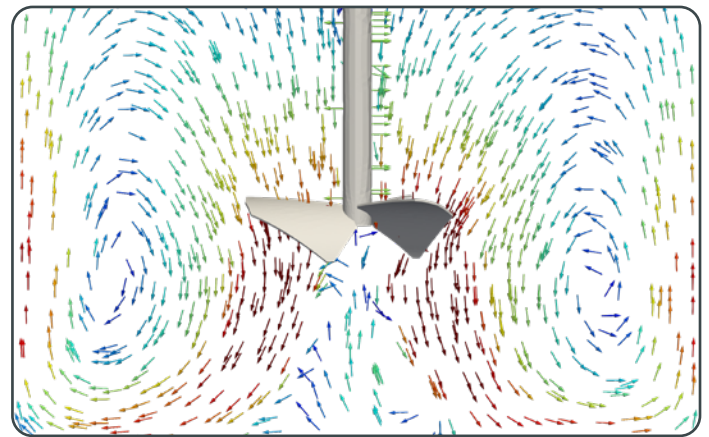
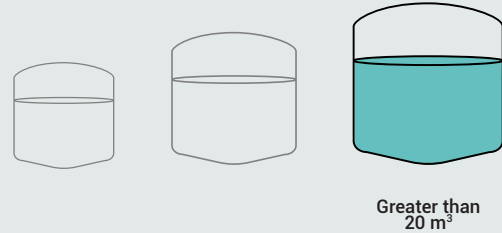

FLOW LINES | SABRE IMPELLER REPRESENTATION

OPTIONAL FEATURES

- ATEX protection
- Stainless steel housing
- Food grade oil
- Food grade epoxy paint
- Full tank disassembly system
- Autonomous cooling system (thermosyphon)



NEED HELP?

autmix.com
Sales | sales@autmix.com
Support | support@autmix.com

INTERNATIONAL COVERAGE
24 / 7 SUPPORT



MEXICO

+52 442 224 5621

UNITED STATES

+1 972 955 0168

SPAIN

+34 914 37 2618